



Project:	
Type:	
Catalog #:	

Model AL13-C Area Light

HOUSING

- Heavy duty two piece aluminum housing w/ powder coated bronze finish
- Fully sealed housing with silicone gasket

ELECTRICAL

- Quad Tap (120/208/240/277)

OPTICAL SYSTEM

- Heat and impact resistant tempered glass lens
- 4KV pulse rated mogul socket
- 100W - 400W HPS
- 100W - 400W PS

MOUNTING

- Swivel Bracket, Slip Fitter and Extruded Mounting arm available

CODE COMPLIANCE

- CSA Listed for wet location
- cUL Listed for wet location

WARRANTY

- 1 year warranty



DIMENSIONS

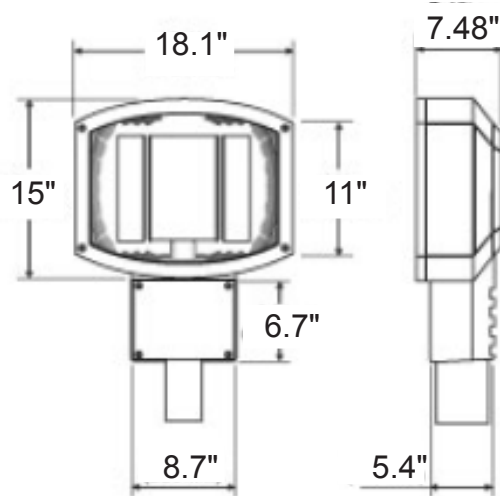

ORDERING INFORMATION

MODEL	WATTAGE		VOLTAGE	OPTIONS
AL13-C	100H	100P	QT	SB - Swivel Bracket
	150H	150P		SF - Slip Fitter
	250H	250P		FLEM - Extruded Aluminum Mounting Arm
	400H	320P		WG - Wire Guard
		350P		GS - Glare Shield
		400P		LG - Polycarbonate Vandal Guard
				BL - Black
				CC - Custom Color

MODEL	WATTAGE	VOLTAGE	OPTIONS
-------	---------	---------	---------

Specifications and dimensions subject to change without notice.